

PLAN VIEW

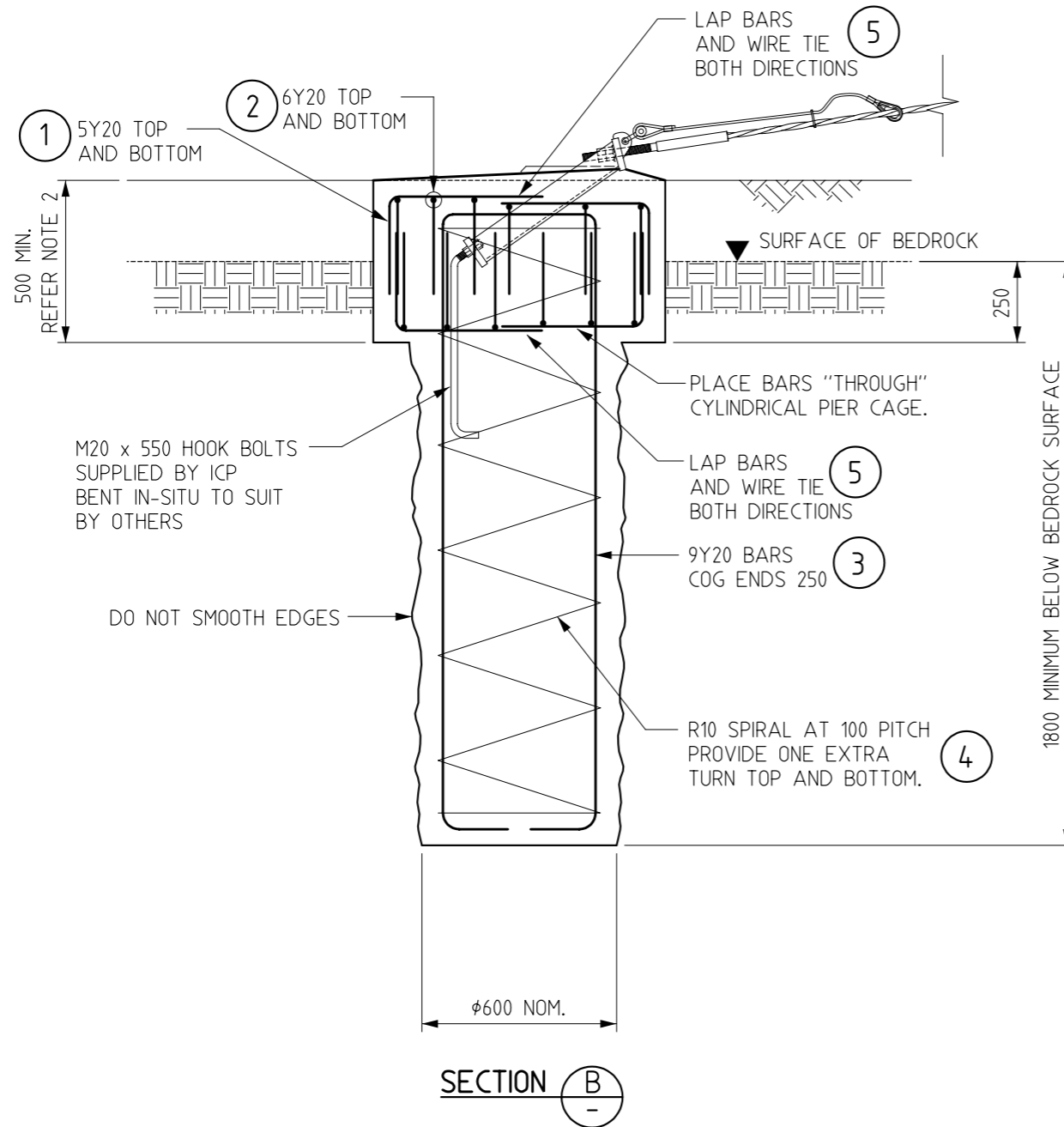

SECTION B

NOTES:

1. THIS ANCHOR ARRANGEMENT TO BE VERIFIED BY A GEOTECHNICAL ENGINEER FAMILIAR WITH THE SITE BEFORE CONSTRUCTION.
2. IF THE DEPTH TO BEDROCK IS GREATER THAN 250mm NOTIFY INGAL CIVIL PRODUCTS' ENGINEERING DEPARTMENT BEFORE CONSTRUCTION.
3. CONCRETE TO BE 32 MPa MINIMUM
4. MINIMUM CLEAR COVER TO BE 50mm
5. INSTALLATION OF ALL FLEX-FENCE COMPONENTS TO BE IN ACCORDANCE WITH INGAL CIVIL PRODUCTS' INSTALLATION DRAWINGS.
6. Y BAR DENOTES GRADE 400Y TO AS1302
R BAR DENOTES GRADE 230R TO AS1302
7. ASSUMED MATERIAL BEARING CAPACITY = 400kPa

REBAR SCHEDULE		QTY
1	Y20 - 300x600 "L" 10 TOP & 10 BOTTOM	20
2	Y20 - 300x500 "L" 12 TOP & 12 BOTTOM	24
3	Y20 - *1950x500 "C" (250 ENDS)	9
4	R10 SPIRAL 100 PITCH *2000 HIGH	1
5	WIRE TIE BARS, IN-SITU.	

*ITEMS 3 AND 4 ARE DEPENDENT ON NOTE 2.

CAD FILE - WRSTD47.DGN 07/04/05

Rev.	Description	Chkd	Date
0	INITIAL ISSUE	D.S.	07/04/05



INGAL Civil Products

127-141 Bath Road, Kirrawee, NSW, 2232 Australia
 Telephone 61-2-9710 5555, Facsimile 61-2-9542 3667, Internet www.ingalcivil.com.au
 © Industrial Galvanizers Corporation Pty Ltd ACN 000 545 415 (2005)
 This drawing is the subject of COPYRIGHT. No part of it may be used, reproduced or copied by any means or in any form without the prior permission of the owner.

PROJECT	WIRE ROPE SAFETY BARRIER
TITLE	φ600 BORED PIER FOOTING ROCK CONDITIONS

DATE	07/04/05	INGAL CIVIL PRODUCTS REFERENCE No.
DRAWN	L.L.	
DESIGNED	M.C.H.	DRAWING No. WR-STD-47 REV.0
CHECKED	D.S.	
MATERIAL	AS SHOWN	
FINISH	AS SHOWN	
SCALE	N.T.S.	